

# M-LENS

## Thick-Ply Expansion Joint

Custom model stainless steel thick-ply expansion joint composed of single- or multi-convolution unrestrained bellow, for mounting with welding ends or flanges up the pipeline.

Available with optional inner sleeve for bellow's protection and improved stability and/or with blocking system. Couplings can be made out of various carbon-steel or stainless steel grades.

For detailed technical specifications on M-LENS axial expansion joints please check the following table and documents or [contact us](#).

### ▶ Features

- ✔ stainless steel bellow
- ✔ thick-ply design
- ✔ optional inner sleeve
- ✔ fully customizable item

### ▶ Technical Specifications



Note | Type M-LENS - Special Design Expansion Joint | 3D view

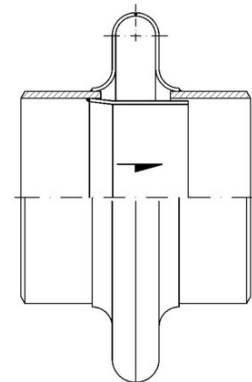

Note | Type M-LENS - Special Design Expansion Joint | sketch

Type	Thick-Ply Stainless Steel
Series	M-LENS
Couplings	*
Size/Range	*
Pressure	*
Axial	yes
Lateral	yes
Angular	yes

\* by individual request

\*\* Pressure thrust restraint can be achieved with blocking bars / acc. to individual request