

# Type C1 Rubber Expansion Joint

Standard model single-flange rubber expansion joint designed for vibrations absorbtion.

EPDM-rubber is vulcanized directly on a DIN flange, thus ensuring the perfect sealing surface and minimal installation length.

For detailed technical specifications on Type C1 rubber expansion joints please check the following table and documents or [contact us](#).



Note | Type C1 (EPDM) - Rubber Expansion Joint | 3D view

## Features

- excellent vibration absorbtion
- self-sealing item
- minimal installation length

## Technical Specifications

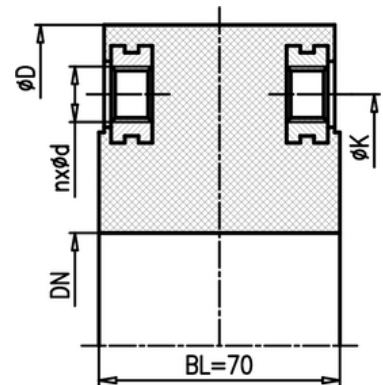

Note | Type C1 (EPDM) - Rubber Expansion Joint | dimensional sketch

Type	Rubber
Series	C1
Couplings	flange
Size/Range	DN20-DN200
Pressure	PN16
Vibrations	yes *

\* this product is intended only to compensate low amplitude vibrations

## ▶ Rubber Quality Chart

Rubber Quality	Mark	Common Applications	Max. Allowed Temperature
EPDM	▼	warm / industrial water	90°C

\* for proper identification of the required rubber quality, please check our complete Rubber Compatibility Chart

## ▶ Standard Program

Nominal Diameter	Overall Length [mm]	Movements		
		Axial [±mm]	Lateral [±mm]	Angular [±deg]
25	70		vibrations	
32	70		vibrations	
40	70		vibrations	
50	70		vibrations	
65	70		vibrations	
80	70		vibrations	
100	70		vibrations	
125	70		vibrations	
150	70		vibrations	
200	70		vibrations	