

Type B3 Rubber Expansion Joint

Standard model single-arch rubber expansion joint composed of single-layer rubber bellow, for mounting with internal-external threads on the pipeline.

Available in various rubber qualities depending on the flow media, different materials for couplings and standard install lengths. Double-arch constructions are available on request.

For detailed technical specifications on Type B3 rubber expansion joints please check the following table and documents or [contact us](#).

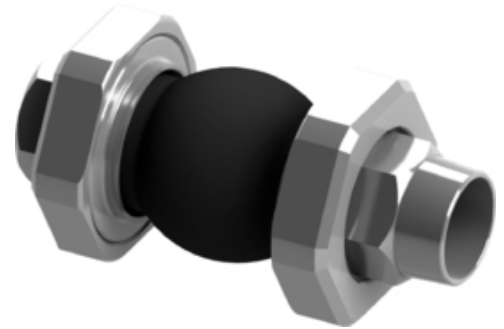

Note | Type B3 (internal-external thread) - Rubber Expansion Joint | 3D view

► Features

- ✔ high flexibility, universal movements
- ✔ installation with internal-external threads
- ✔ various rubber qualities

► Technical Specifications

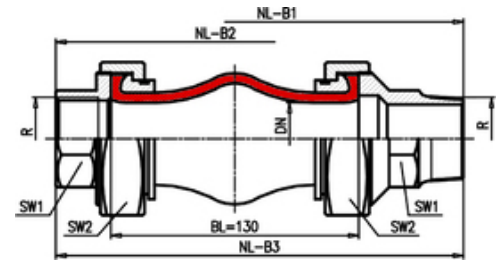

Note | Type B3 (internal-external thread) - Rubber Expansion Joint | dimensional sketch

Type	Rubber
Series	B3
Couplings	mixed threads
Size/Range	DN20-DN50
Pressure	PN16
Axial	yes *
Lateral	yes *
Angular	yes *

* acc. to individual design or standard program

▶ Rubber Quality Chart

Rubber Quality	Mark	Common Applications	Max. Allowed Temperature
NEOPRENE	▼	water	70°C
EPDM	▼	warm / industrial water	90°C
EPDM-SP	▼	hot water / heating systems	110°C
NITRIL	▼	oils	80°C
NITRIL	▽	food grade applications	80°C
HYPALON	▼	acids	80°C
BUTYL	▼	potable water	90°C
VITON	▼	strong acids	90°C

* for proper identification of the required rubber quality, please check our complete Rubber Compatibility Chart

▶ Standard Program

Nominal Diameter		Overall Length [mm]	SW1 [mm]	SW2 [mm]	Movements		
[mm]	[inch]				Axial [+/-mm]	Lateral [+/-mm]	Angular [+/-deg]
20	3/4"	207	36	80	30	30	30
25	1"	214	40	80	30	30	30
32	1 1/4"	221	48	80	30	30	30
40	1 1/2"	226	53	90	30	30	30
50	2"	235	66	110	30	30	30